

HONDA

INSTALLATION INSTRUCTIONS

Accessory

FRONT
AUDIO CONSOLE

Application

'92 CIVIC
'93 CIVIC

Publications No.

Issue Date
SEPT. 1994

PARTS LIST

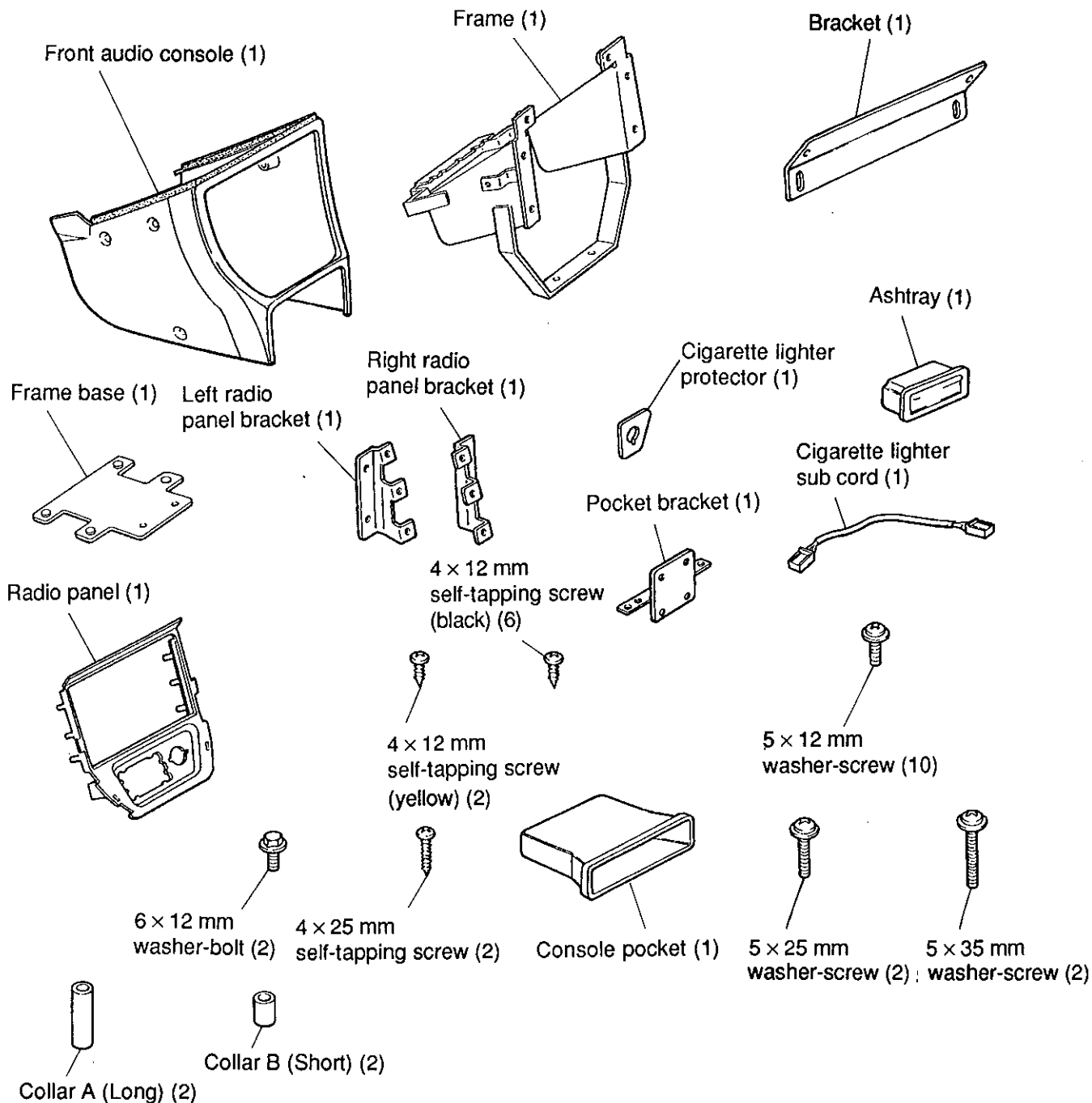

TOOLS REQUIRED

- Phillips® screwdriver
- Stubby Phillips® screwdriver
- 10 mm Open-end wrench
- Electrical insulating tape

INSTALLATION

- This audio console kit is designed to be used exclusively with Civic compact disc player, graphic equalizer or CD changer controller, which are sold separately. Have the recommended compact disc player, graphic equalizer or CD changer controller on hand at the time of installation.
 - These instructions are for the compact disc player installation. The same procedure applies to the graphic equalizer or CD changer controller.
 - Disconnect the negative cable from the battery before installing the console. The memory of the radio will be erased when the negative cable is disconnected from the battery. Write down the station numbers so the radio can be reset after the installation.
 - Be extremely careful not to damage the instrument panel, console and other finished surfaces of the body.
1. Remove the screw lid from the front console.
 2. Remove the two screws concealed under the lid and the two self-tapping screws fastening the front console. Remove the instrument panel lower cover and front console.

Fig. 1

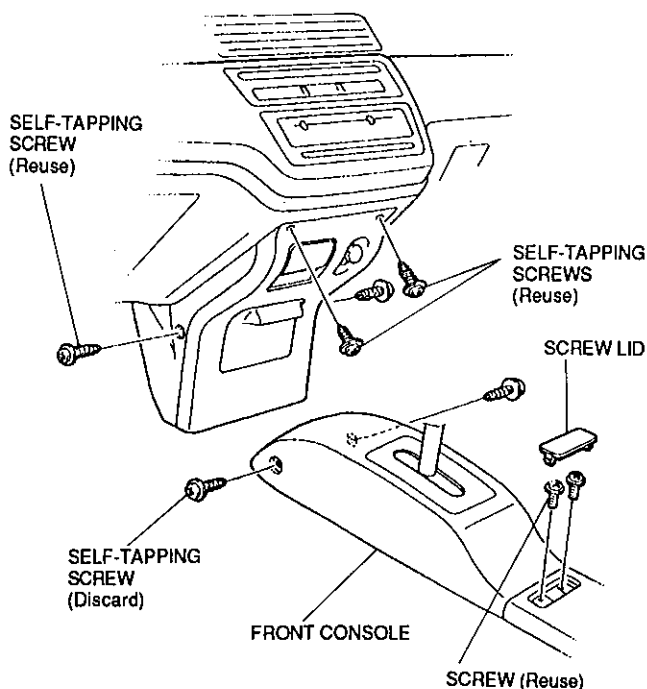

3. Unplug the car's harness from the cigarette lighter.
4. Remove the cigarette lighter from the lower cover.

Fig. 2

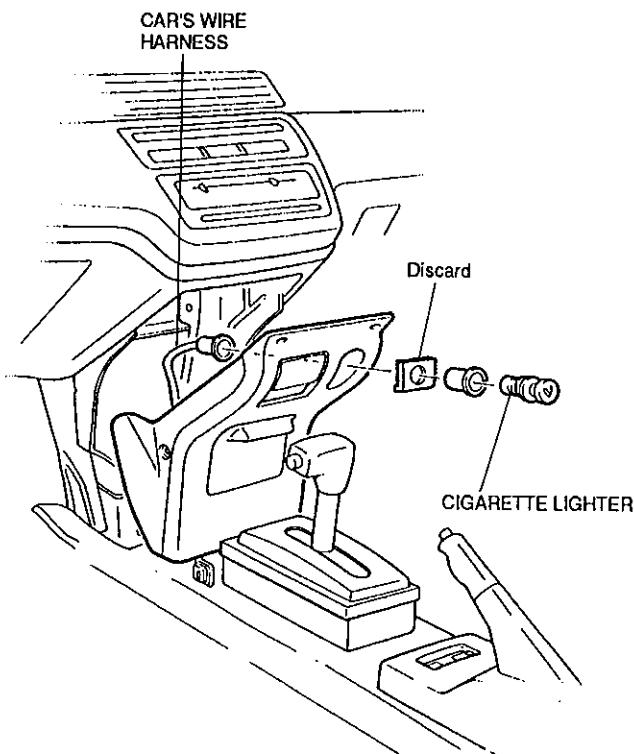

5. Remove the cup holder from the front console.
6. Remove the cup holder from the front console and install the frame base using the two long and two short collars A and B, two 5×25 mm washer-screws and two 5×35 mm washer-screws. Tighten the screws securely.

Fig. 3

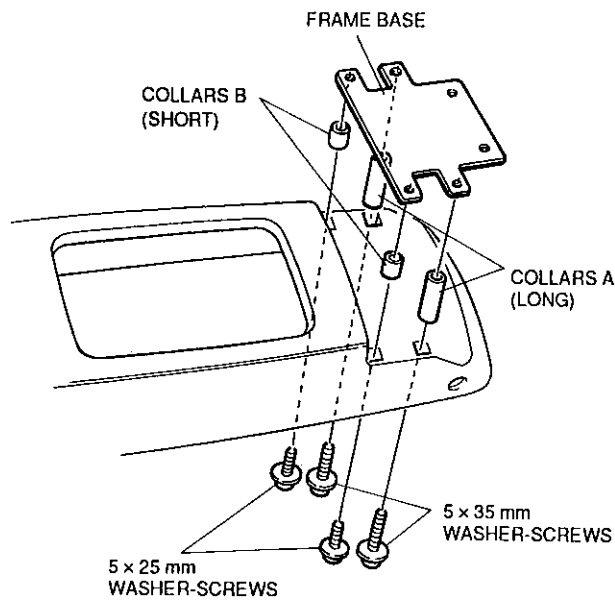

7. Attach the rear of the front console using the two screws, then press the lid into position on the console.
8. Locate the bracket provided and attach the bracket to the instrument panel using the two self-tapping screws removed in step 2.
 - Push the bracket as far forward as possible when installing the bracket.
9. Position the frame on the bracket and frame base and install the frame on the bracket using the two 5×12 mm washer-screws and on the base using the two 6×12 mm washer-bolts.
 - Push the frame as far forward as possible when installing the frame.

Fig. 4

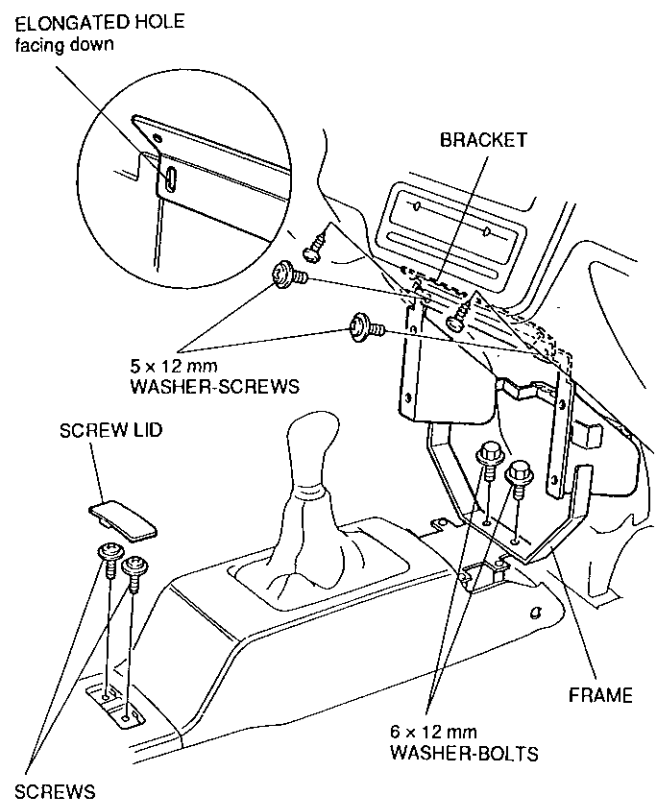

10. Position the right and left radio panel brackets on the radio panel and install the three 4 × 12 mm self-tapping screws (black) for each. Tighten the screws securely.
11. Secure the cigarette lighter on the radio panel with the protector.
 - Align the lug on the lighter with the cutout in the protector.
12. Pull the bulb out of the socket on the car's wire harness and secure the socket to the car's wire harness using a insulating tape, as shown.
 - Cover the bulb opening of the socket with the tape when securing the socket with a tape.
13. Connect the cigarette lighter sub cord to the cigarette lighter.

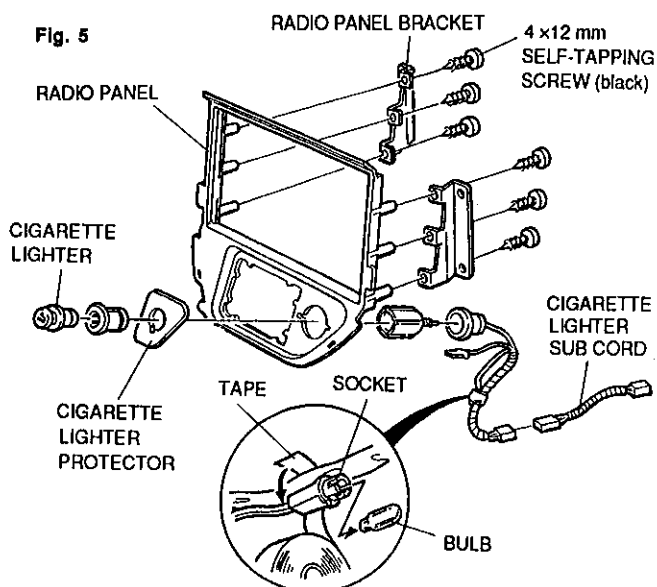

14. Connect the cigarette lighter sub cord to the car's wire harness.
15. Position the radio panel on the frame and install the four 5 × 12 mm washer-screws. Tighten the screws securely.

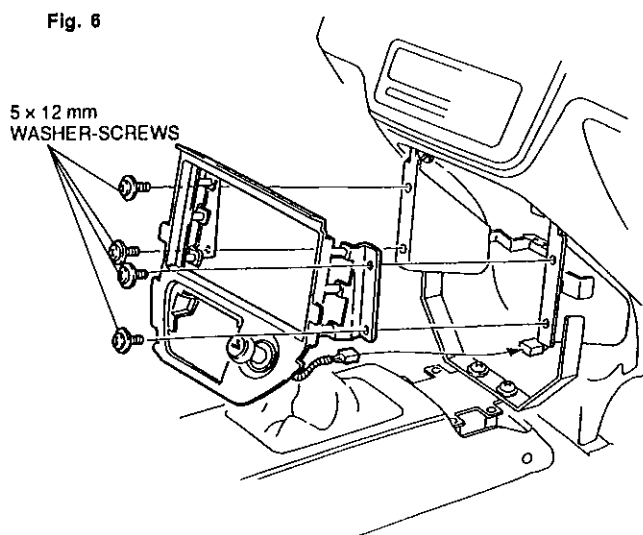

16. position the compact disc player or graphic equalizer on the console pocket, then temporarily attach the pocket bracket to the rear of the compact disc player using the 4 mm screws furnished with the kit. Align the lower holes in the pocket bracket with the holes in the pocket and install the two 4 × 12 mm self-tapping screws (yellow). Tighten screws securely.
17. Temporarily install the two 5 × 12 mm washer-screws provided in the inner holes in the pocket bracket as shown.

Fig. 7

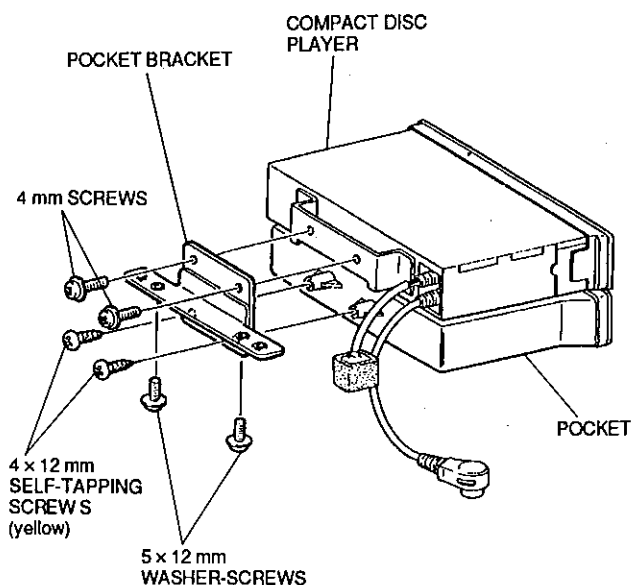

18. Remove the radio lid from the instrument panel.
19. Unplug the 16-pin connector and antenna feeder from the radio lid.

Fig. 8

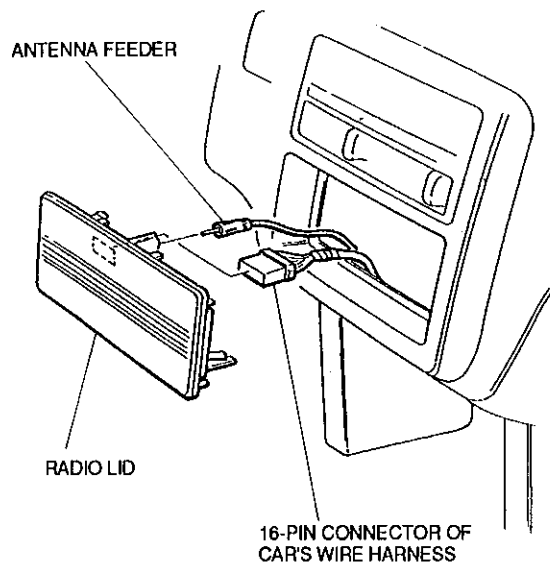

20. Remove and discard the short plug from the rear of the radio/cassette player (sold separately).

Fig. 9

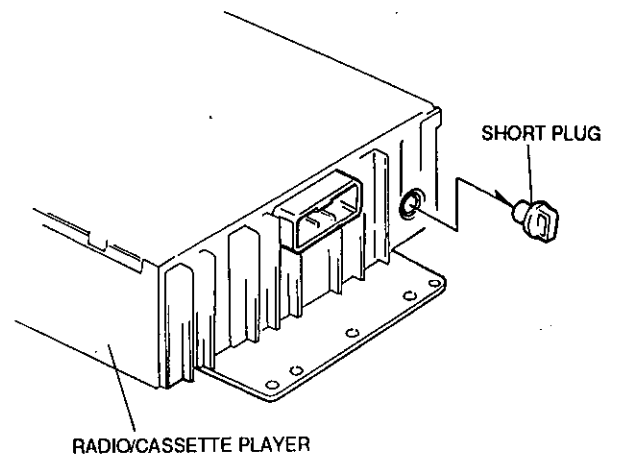

21. Connect the 16-pin connectors of the compact disc player to the 16-pin connectors of the car's harness and radio/cassette player.
22. Plug the DIN connector of the DIN cable from the compact disc player into the rear of the radio/cassette player.
 - Refer to fig.10-a for the graphic equalizer installation.
 - Refer to fig.10-b for the CD changer controller installation.

Fig. 10

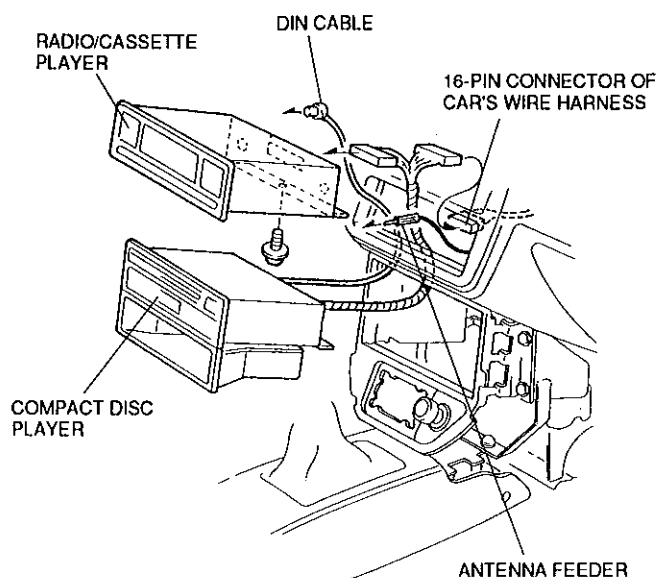

Fig. 10-a

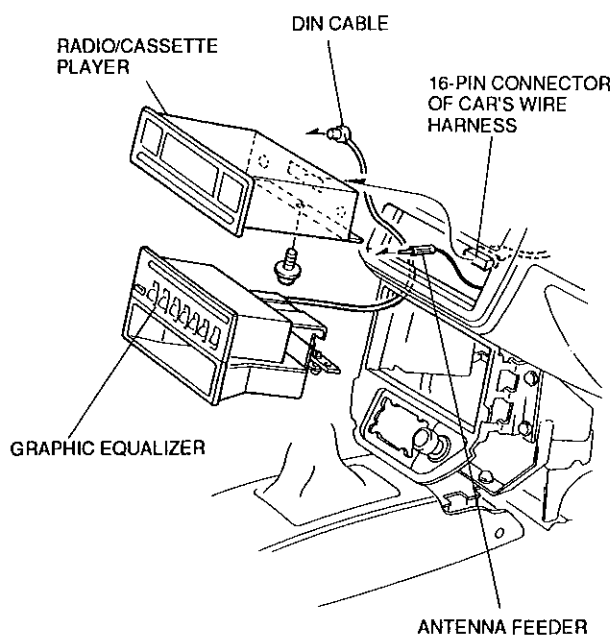
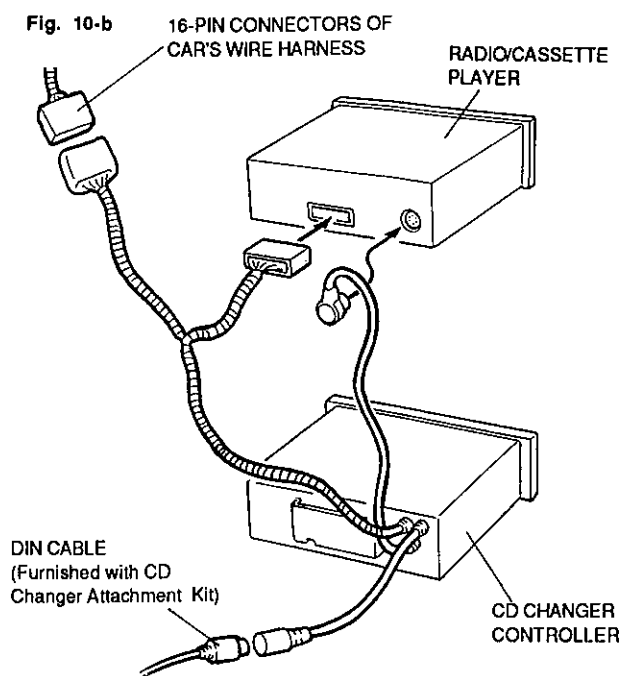
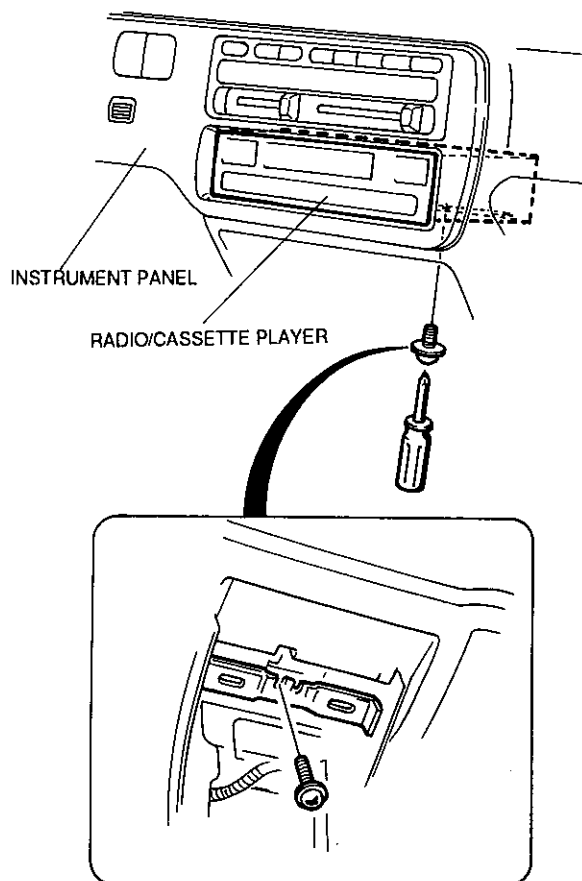

Fig. 10-b



23. Slide the radio/cassette player into the opening of the instrument panel. Install the 5 mm screw included in the radio/cassette player kit as shown. Tighten the screw securely.

Fig. 11



24. Secure the compact disc player/pocket assembly to the frame by tightening the 5 × 12 mm washer-screws installed in step 17.

Fig. 12

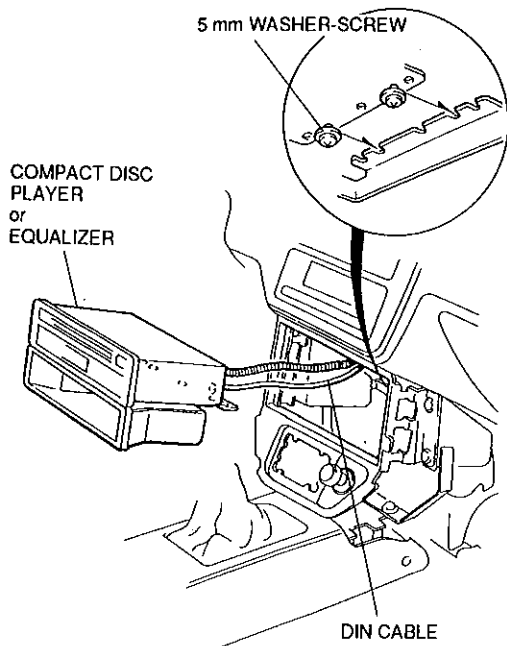

25. Place the front audio console in its position over the compact disc player and pocket.
26. Install the 4 × 12 mm self-tapping screws, 5 × 12 mm washer-screws and 4 × 25 mm self-tapping screws as shown.

Fig. 13

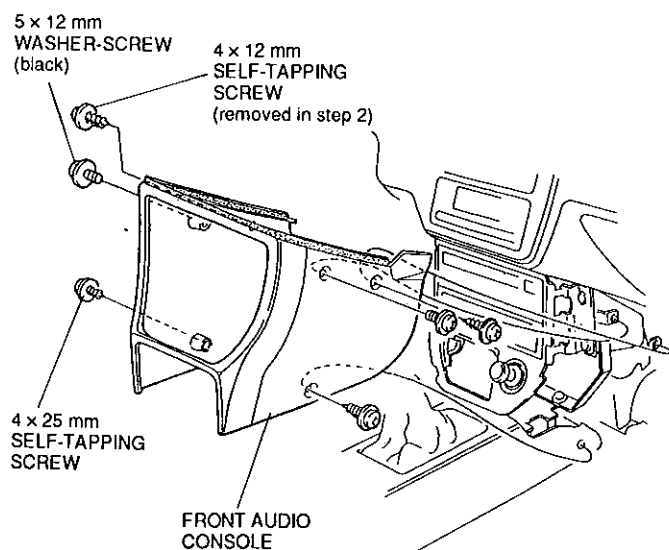

27. Reinstall the front console using the hardware removed in steps 1 and 2.
28. Slide the ashtray into position in the radio panel.

Fig. 14

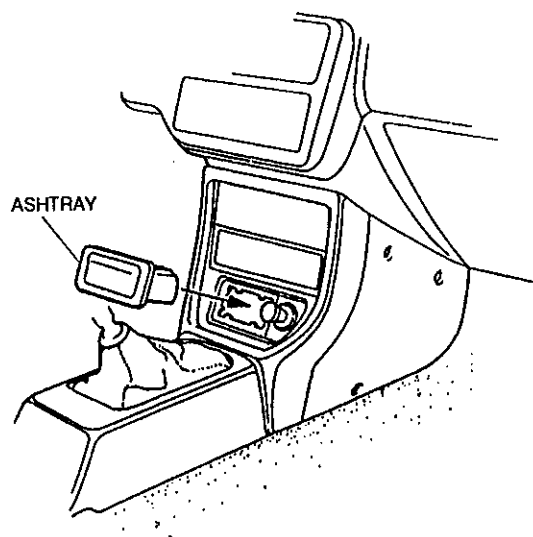

29. Check that all the wire harnesses and cables are routed properly and all connectors are plugged in.
30. Connect the negative cable to the battery and check operation of the headlights, turn signals, etc.
31. Check the radio/cassette player and compact disc player operation in accordance with the instructions described in the Owner's Manual.
32. Reset the radio and clock.

READ OWNER'S MANUAL CAREFULLY. The owner's manual has important safety and operation information.

These instructions should be considered a permanent part of the vehicle and should remain with the vehicle if sold.